

32010

鑽石修整器 DIAMOND CBN FLAT WHEEL TRUER

● MCL-ET100



● MCL-ET110.MCL-ET220

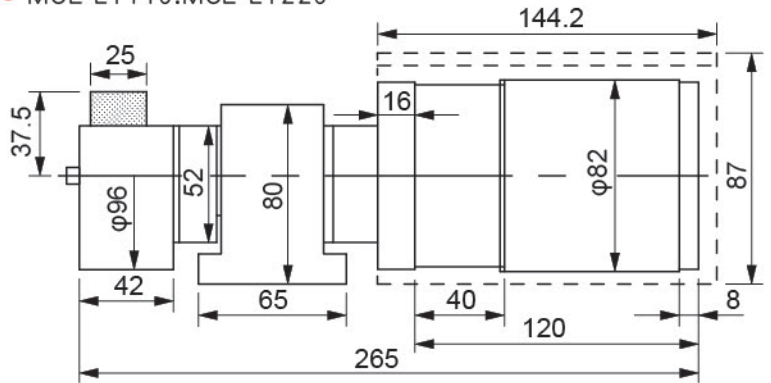

● MCL-ET100

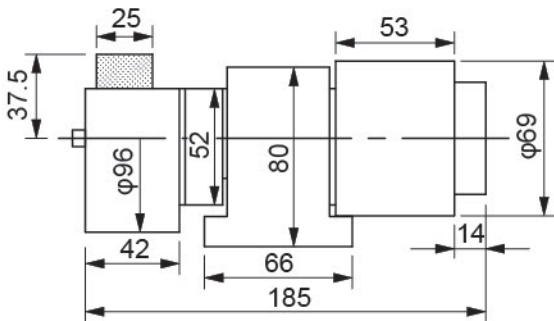

- 利用樹脂砂輪磨料，專門修整鑽石平面砂輪用。
- 主軸採精密軸承可高速旋轉，可確保精度及穩定性。
- The grinding wheel is made of resin, especially for diamond flat wheel.
- The spindle could be milled high-speed rotation with precision bearings. To ensure accuracy and stability.

單位:mm

訂購編號 Order No.	型號 Model	馬達 Motor	重量(kg) Weight
32010	MCL-ET100	-	4.5
32010-11	MCL-ET110	110V/60Hz 單相(1Phase)	6.5
32010-22	MCL-ET220	220V/60Hz 單相(1Phase)	6.5

32018

透視砂輪修整器 OPTICAL RADIUS ANGLE DRESSER

● MCL-E180

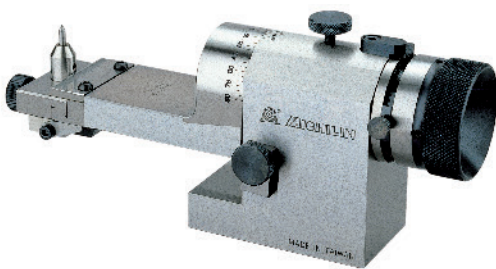

- MCL-E180 Visit Universal Wheel Dresser Adoptable on Surface grinder and universal tool grinder for dressing grinding wheel into various cross sections of flat or curved shapes.
- By "SIGHTING" the diamond point through the lens, radial and angle can easily be made perfectly tangent-Visually-Even with diamonds. Likewise radial can be blended together with most unbelievable accuracy.

- 適用於平面磨床和萬能工具磨床。
- 可修整各種角度和凸凹R，並可透過視鏡觀察鑽石筆尖修整砂輪表面接觸之情形，可精確的修整細小圓弧或度。

■規格:

- 中心高度:65mm
- 最大修整砂輪範圍:φ 200mm
- 凸R修整最大半徑:10mm
- 凹R修整最大半徑:24.4mm
- 滑板修整行程:22.5mm
- 修整角度:90° ~0° ~95°
- 重量:4.2kg

■Specifications:

- Center height:65mm
- Max. wheel diameter:φ 200mm
- Max. convex radius:10mm
- Max. concave radius:25.4mm
- Tangential travel:22.5mm
- Dressing angle:90° ~0° ~95°
- Weight:4.2kg

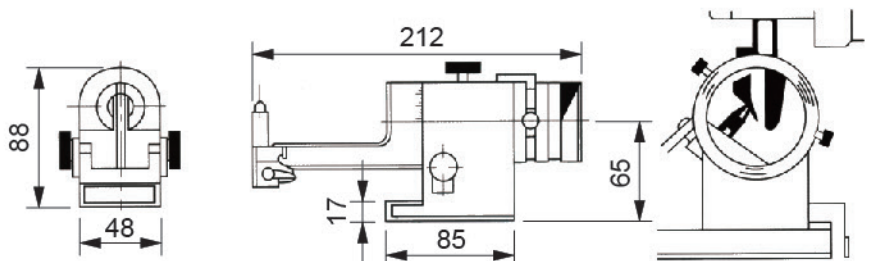



32028

砂輪修整器 RADIUS AND ANGLE DRESSER

● MCL-E280

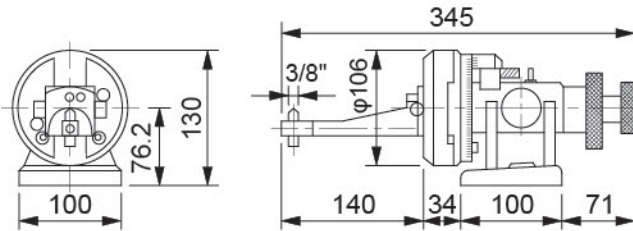
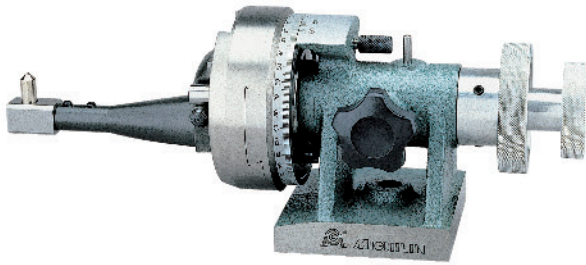

- 適用於平面磨床，可修整R角，也可修整各種角度。
- 計算R角時，以圓棒來校正本機中心高度。
- For surface grinder, can be used for R angles and variety of angles.
- When calculating R angle, correct the height of machine center with round rod.

■規格:

- 最大修整砂輪直徑210mm(8")
- 凸R修整範圍45mm
- 凹R修整範圍100mm
- 滑板左右行程65mm
- 重量:9kg

■配件:

1. 中心高度標準PIN
2. 鑽石筆1支

■Specifications:

- Max. wheel diameter: ϕ 210mm(8")
- Max. convex R:45mm
- Max. concave R:100mm
- Tangential travel:65mm
- Weight:9kg

■Accessory:

- Standard Pin of center's height
- Diamond pen--- 1 piece



32029

砂輪修整器 RADIUS AND ANGLE DRESSER

● MCL-E290

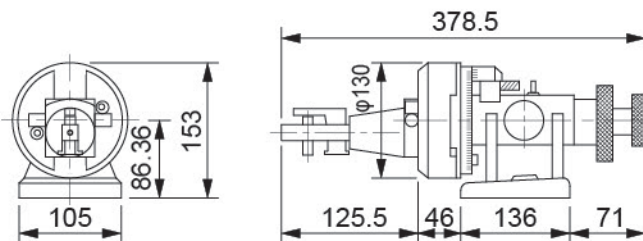
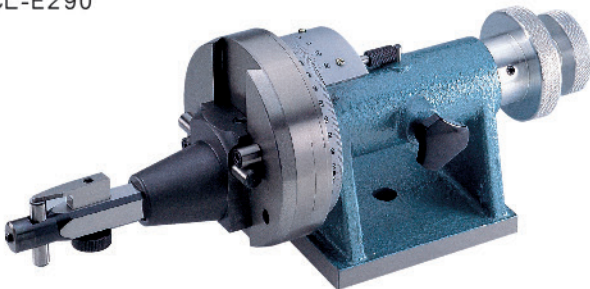

- 適用於平面磨床，可修整R角，也可修整各種角度。
- 自動歸零設計，以固定迴旋中心高度，只要配合塊規使用，就可輕易完成你所需要R角。
- For surface grinder, can be used for R angles and variety of angles.
- Auto-zero designed, the R angle of demand can be easily done with the block in fixed height of swing center.

■規格:

- 最大修整砂輪直徑210mm(8")
- 中心滑軌可伸縮25mm
- 凸R修整範圍60mm
- 凹R修整範圍150mm
- 滑板左右行程90mm
- 重量:9.5kg

■配件:

1. 鑽石筆1支

■Specifications:

- Max. wheel diameter: ϕ 210mm(8")
- The slide of center is retractable to 25mm.
- Max. convex R:60mm
- Max. concave R:150mm
- Tangential travel:90mm
- Weight:9.5kg

■Accessory:

- Diamond pen--- 1 piece



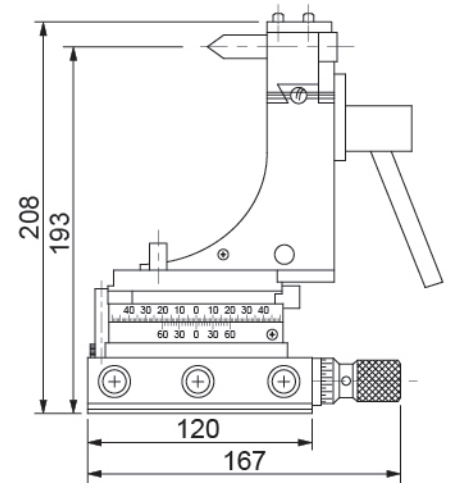
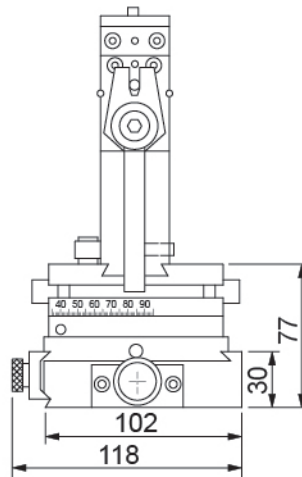

- 萬能砂輪修整器，適用於平面磨床和萬能工具磨床。
- 滑動底座設計，配合迴旋座及上滑座，可修整任何直線角度和圓弧組成的各種截形砂輪。

■規格:

- 底部到鑽石筆中心高度:193mm
- 量測基準梢直徑: ϕ 10mm
- 修刀擺動最大距離: \pm 14mm
- 修整砂輪最大直徑: ϕ 200mm
- 凸R修整範圍50mm
- 凹R修整範圍0~100mm
- 轉盤刻度單位每格5'
- 手動進刀最大移動量25mm
- 進刀手輪刻度單位每格0.01mm

■配件:

- 1.毛刷1支。
- 2.鑽石筆1支。

- MCL-E380 Universal wheel dresser adoptable on surface grinding and universal tool grinder for dressing grinding wheels into various cross sections of flat or curved shapes.

■ Specifications:

- Center height:193mm
- Measuring quasi-pin dia: ϕ 10mm
- Max. swing distance of diamond cutter: \pm 14mm
- Max. wheel diameter: ϕ 200mm
- Max. convex R:50mm
- Max. concave R:0~100mm
- Reading accuracy of turret index:5'
- Max.translation of feed:25mm
- Feed per division of handle scale:0.01mm

■ Accessory:

- 1.Brush--- 1 piece
- 2.Diamond pen--- 1 piece

※使用方法

計算公式:

- ◆ 歸零:H=L= 零R
- ◆ H=兩準梢外的距離
- ◆ L=鑽石筆尖至基準板的距離
- ◆ R=所需修整的圓弧半徑
- ◆ 修整凸R圓弧:H=L+R
- ◆ 修整凹R圓弧:H=L-R

1. 修整範例(凸R30mm):如測得L=60mm。
計算H=L+R.=60+(+30)=90mm。
減H兩準梢直徑(10X2)=90-20=70mm。
將70mm之塊規夾於兩準梢中間，可修整凸R30mm。
2. 修整範例(凹R30mm):如測得L=60mm。
計算H=L-R. =60-(-30)=30mm。
減H兩準梢直徑(10X2)=30-20=10mm。
將10mm之塊規夾於兩準梢中間，可修整凹R30mm。

※Application method

Formula:

- ◆ H=L=0 R
- ◆ To dress convex arc surface:H=L+R
- ◆ To dress concave arc surface:H=L-R
- ◆ H: Distance between outer generating line of two locating pins.
- ◆ R: Radius of the arc surface to be dressed.
- ◆ L: Distance from tip of diamond cutter to base plate.

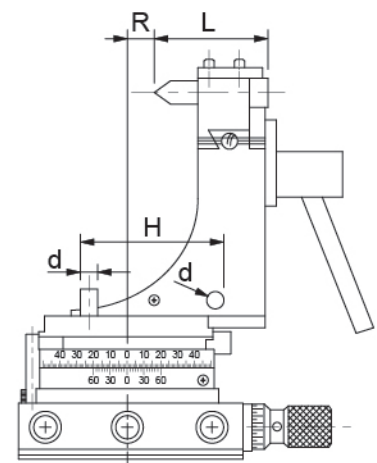



32048

雙面砂輪修整器 PRECISION DUPLEX DRESSER

● MCL-E480

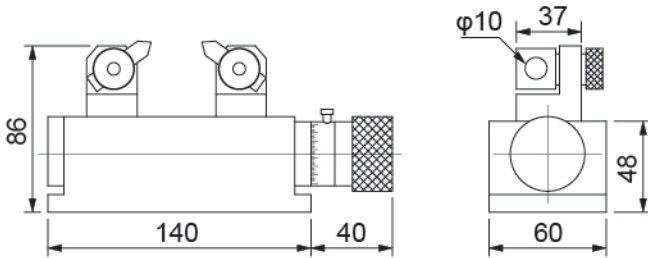
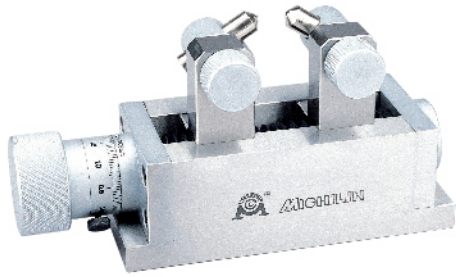

■規格:

- 最大修整深度:40mm
- 最大修整厚度:40mm
- 最小修整厚度:0.2mm
- 刻度行程單位:0.02mm
- 重量:3.5kg

■配件:

1. 鑽石筆2支

■Specifications:

- Max. width of wheel:40mm
- Max. dressing depth:40mm
- Mini dressing width:0.2mm
- Graduation:0.02mm
- Weight:3.5kg

■Accessory:

1. Diamond pen--- 2 pieces

● 適用於平面磨床，可達到固定厚度之精密修整器。

● 可同步修整砂輪兩側厚度，亦可作單面修整。

● Suitable for surface grinder and the precision can reach the dresser with fixed thickness.

● Wheel dressing can be synchronized the thickness of both sides and single-sided.

32050

砂輪角度修整器 ANGLE SINE DRESSER

● MCL-P48

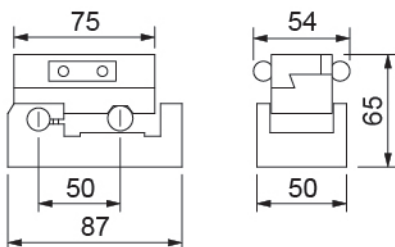
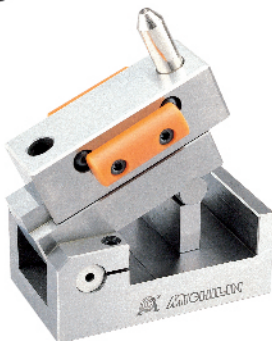

※使用範例

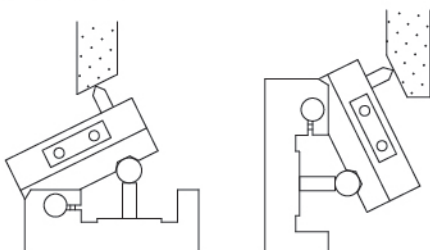

● 專為修整平面砂輪角度，可臥立兩用，角度修整範圍大。

● 利用兩邊螺絲固定鬆緊，可搭配角度墊塊使用，達到所需角度。

● 將滑軌取下，亦可當50MM之正弦規使用。

● Special for dressing the angle of Grinding wheel, and can be used vertical and horizontal with large range.

● Use the screws to adjust the tightness, and assort with the angle block to achieve the required angle.

● Remove the slide, the one can be used as the 50MM sine block.

■規 格:

- 平行精度:0.005mm
- 兩墊輪中心距離:50mm
- 角度修整範圍:
(臥)0~60° (立)45~90°
- 修整行程長度:60mm
- 重量:1.5kg

■配件:

1. 鑽石筆1支

■Specifications:

- Parallelism within:0.005MM
- The center's distance of spacer:50MM
- The dressing range of angle:
(Horizontal)0~60° (Vertical)45~90°
- The dressing range of length:60mm
- Weight:1.5kg

■Accessory:

1. Diamond pen--- 1 piece

32070

砂輪修整器 CONCAVE CONVEX FORMING DRESSER

● MCL-P55

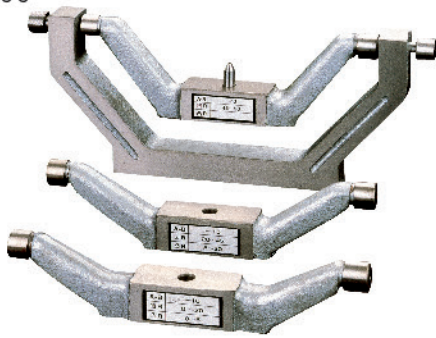

- 設計利用擺盪原理，由頂針固定中心點，前後擺盪修整。
- 操作簡易，利用高度規或高度游標卡尺可加減中心高度。

■規格:

- 最大修整砂輪直徑:210mm(8")
- 小擺盪修整範圍:凸R 0.5~6mm ° 凹R 0.5~20mm
- 中擺盪修整範圍:凸R 0.5~20mm ° 凹R 20~45mm
- 大擺盪修整範圍:凸R 0.5~40mm ° 凹R 45~90mm

● 重量:6.2kg

■配件:

1. 鑽石筆1支。
2. 固定頂針2支。

- Designed with principle of swing. Fixed the thimble by center, and dressed front and rear by swing.
- Easy to operate, use the height block or height caliper can add and subtract the height of center.

■Specifications:

- Maximum dressing diameter of grinding wheel:210mm(8")
- The dressing range of small swing:convex R 0.5~6mm ° concave R 0.5~20mm
- The dressing range of middle swing:convex R 0.5~6mm ° concave R 0.5~20mm
- The dressing range of large swing:convex R 0.5~40mm ° concave R 45~90mm
- Weight:6.2kg

■Accessory:

1. Diamond pen--- 1 piece
2. Center for fixed--- 2 pieces

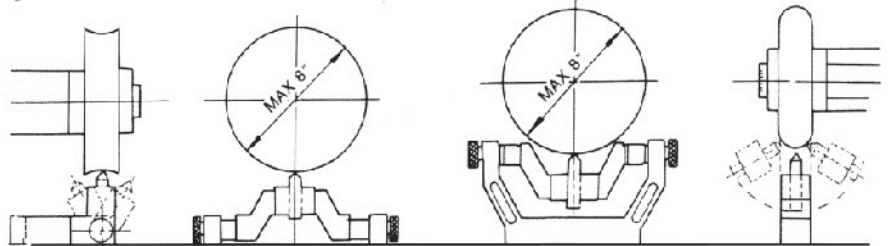

32085

砂輪平行修整器 PERIPHERAL ACCESSORIES FOR MACHINING CENTERS

● MCL-E10

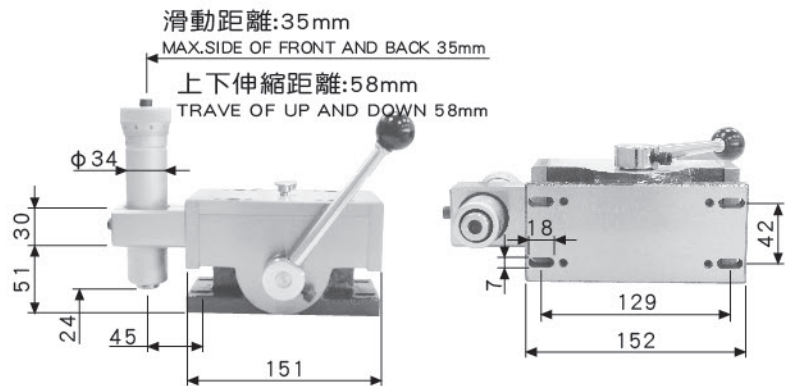
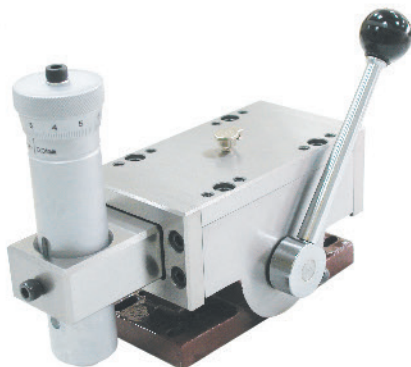

- 安裝於平面磨床主軸上來進行平行修整，比傳統修整器有較高的效率和方便性。
- 直線慣性滑動，可使修整砂輪更平順。
- 滑動軌間隙調整螺栓，位於滑動座中間，可使修整砂輪精確度更高。
- 修整管最小進刀量0.01mm(0.0005")。

- Thread forwards the slide to make dressing more smoothly.
- Adjustment screw is set between the slide and diamond cutter dead axle. It makes processing more easily, with high precision.
- Mainly E10 can do verprecision dressing, which can not be done by old model.
- Min scale of feed is 0.01mm(0.0005").

■配件:

1. 擋片一塊。
2. 鑽石筆1支。
3. M5六角扳手1支。
4. 六角承孔頭螺絲M6×10L×4支。
5. 六角頭螺絲1/4"-20UNC×25L×4支。
6. 華司×4個。

■Accessory:

1. Block of stopper--- 1 piece
2. Diamond pen--- 1 piece
3. Hexagon type spanner 5MM--- 1 piece
4. M6 Screw--- 4 pieces
5. Hexagon screw 1/4"-20UNC×25L--- 4 pieces
6. Washer--- 4 pieces

訂購編號 Order No.	型號 Model	重量(kg) Weight
32085-10	MCL-E10(mm)	7.7
32085-15	MCL-E10(inch)	7.7



32085

砂輪平行修整器 PERIPHERAL ACCESSORIES FOR MACHINING CENTERS

● MCL-E15

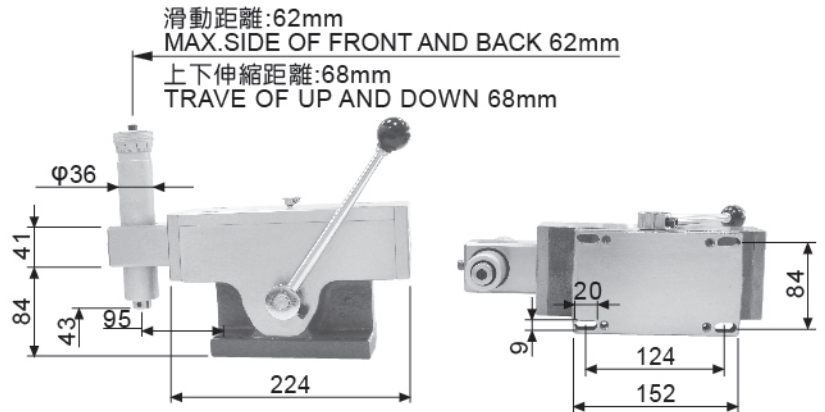
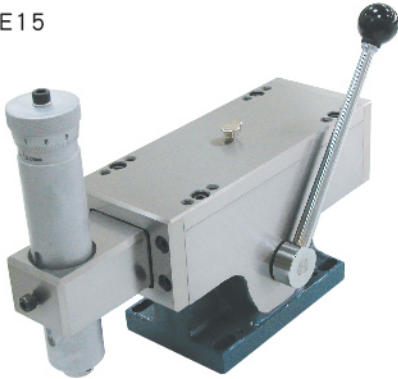

- 直線慣性滑動，可使修整砂輪更平順。
- 滑動軌間隙調整螺栓，位於滑動座中間，可使修整砂輪精確度更高。
- 修整管最小進刀量0.01mm(0.0005")。
- 滑動長度：約62mm。
- Thread forwards the slide to make dressing more smoothly.
- Adjustment screw is set between the slide and diamond cutter dead axle. It makes processing more easily, with high precision.
- Min. scale of feed is 0.01m/m(0.0005").
- Max.side of front and back 62mm.

■ 配件:

1. 上、下擋片各一塊
2. 擋片固定條×2支
3. φ10×35L鑽石筆1支
4. M5六角扳手1支
5. 六角承孔頭螺絲M6×20L×4支
6. 六角頭螺絲1/4"-20UNC×30L×4支
7. 華司×4個

■ Accessory:

1. Top and Bottom stopper block each--- 1 piece
2. Fixed batten for Stopper block--- 2 pieces
3. φ10×35L diamond pen--- 1 piece
4. Hexagon type spanner 5mm--- 1 piece
5. M6×20L Screw--- 4 pieces
6. HEXAGON SCREW 1/4"-20UNC x 25L--- 4 pieces
7. Washer--- 4 pieces

訂購編號 Order No.	型號 Model	重量(kg) Weight
32085-20	MCL-E15(mm)	11.6
32085-25	MCL-E15(inch)	11.6

32086

進刀管 FEED SHAFT

●報價均不含鑽石筆 DIAMOND PEN NOT INCLUDED



● φ34×0.01mm

● φ36×0.01mm

- 有公制與英制兩種規格，也可配合其他修整器使用。
- 進刀刻度(公制)0.01mm，(英制)0.005"。
- There are two specifications of metric and inch, which can be used with other dresser.
- Scale of Feed (metric)0.01mm (inch)0.005".

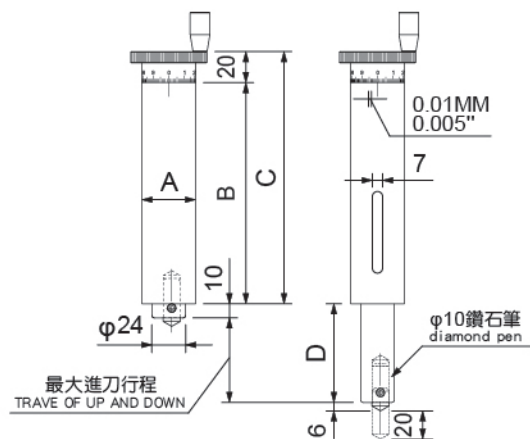

單位:mm

訂購編號 Order No.	型號 Model	A	B	C	D	刻度 Min. scale of feed	最大進刀行程 Trave of up to down	重量(kg) Weight
32086-34	E10-φ34(M)	34	120	140	20	0.01mm	24	0.9
32086-35	E10-φ34(I)	34	120	140	20	0.005"	24	0.9
32086-36	E15-φ36(M)	36	150	170	40	0.01mm	43	1.2
32086-37	E15-φ36(I)	36	150	170	40	0.005"	43	1.2

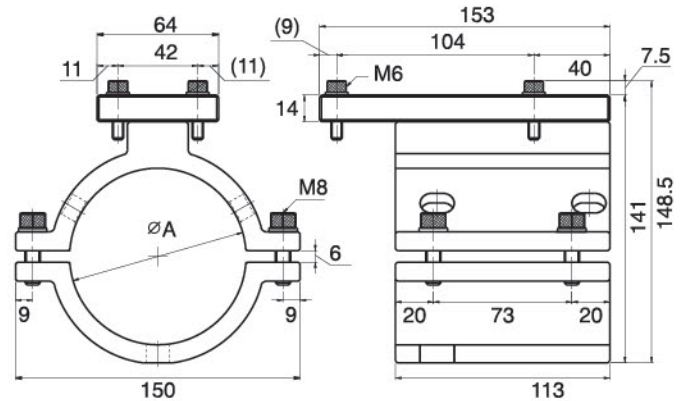

前、後位移最行程 40mm
MAX. SIDE OF FRONT AND BACK 40MM

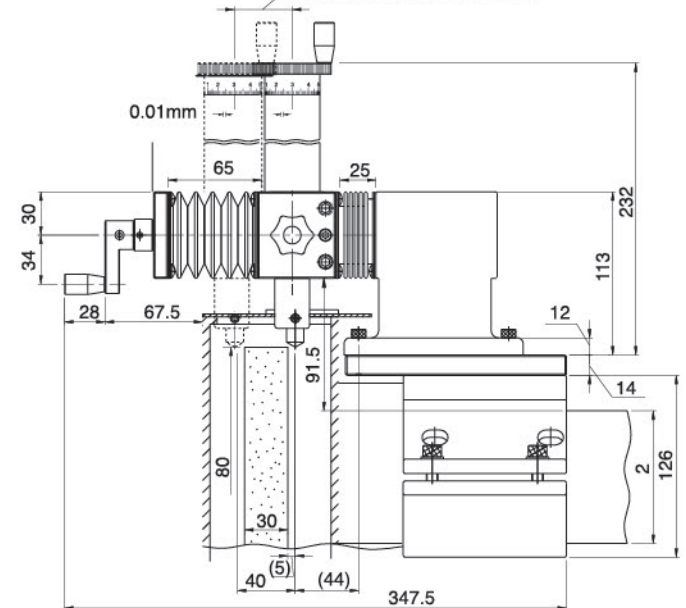

- 此套筒是配合E20砂輪修整器使用，固定於平面磨床主軸上，以確保砂輪修整器之穩定。
- 配合不同之平磨機器規格，有93與95mm兩種尺寸。
- Sleeve is used with E20 wheel dresser, which is installed on small surface grinder. Regularly, the spindle holder of small surface grinder is round. Wheel dresser has to be used with round sleeve than can be installed on small surface grinder.
- Material of the sleeve is aluminium alloy and inside dia. is 93mm or 95mm.

訂購編號 Order No.	φ A	重量(kg) Weight
32087-93	φ93	2.2
32087-95	φ95	2.2

32116-10

砂輪角度修整器 ANGULAR TRUING ATTACHMENT, TABLE-MOUNTED TYPE

- AD-160

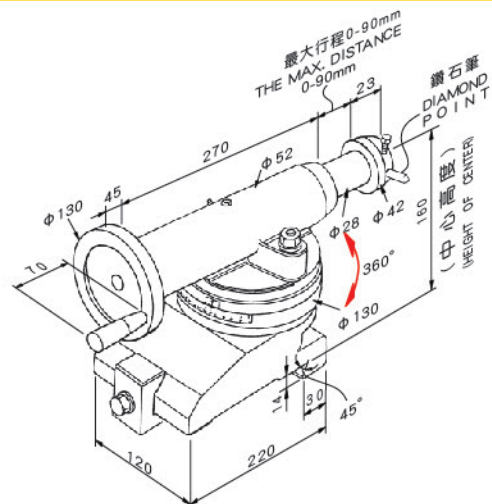

- 適用圓筒磨床，安裝於床台上來進行角度修整。
- 圓盤刻度設計，操作簡易，可以旋轉到你要的角度。
- 具有防塵設計，滑動軌硬度HRC55~57°
- 砂輪修整管修整行程:0 ~ 90mm。
- 重量:18kg。

- Apply in the circular grinding machine. Installed in flat table and proceeding press the angle.
- The disk is scale designed, and easy to operate. Can be rotated to any angle that you need.
- Dust protection designed. The Hardness of movable track is HRC55 ~ 57° .
- The prune distance of the prune tube: 0 ~ 90mm.
- Weight:18kg.